

SH47

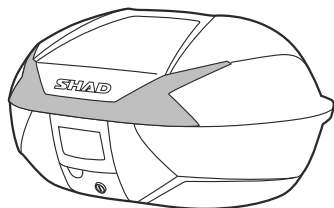

SH46

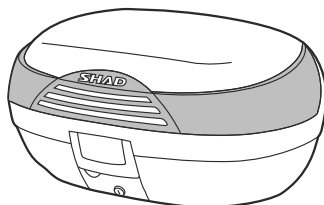

SH45

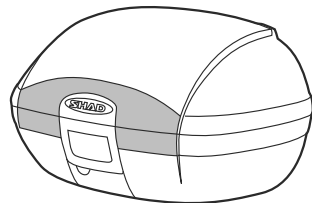

SH44

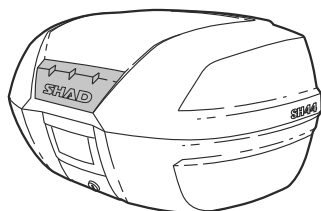

SH42

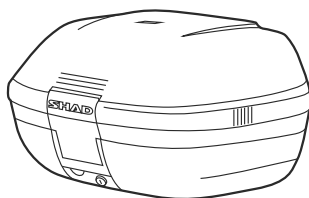

SH40 SH40 CARGO

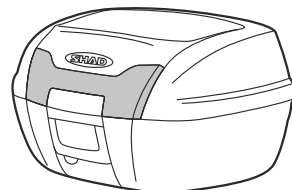

ACCESSORIES (OPTIONAL)

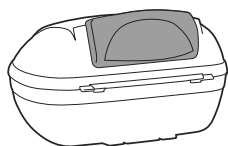

Backrest

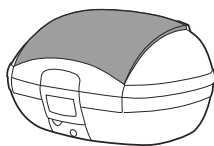

Colour cover



Brake light
Ref. D0B40KL

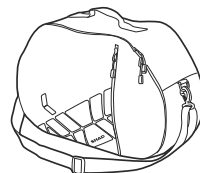

Inner Bag
(SH42, SH44, SH45, SH46, SH47)

Find out about other products at

WWW.SHAD.ES

CLOSE

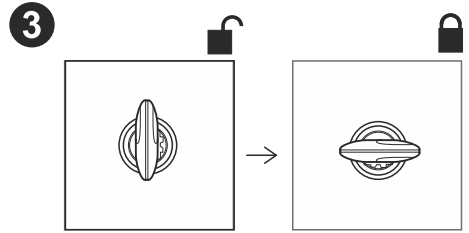
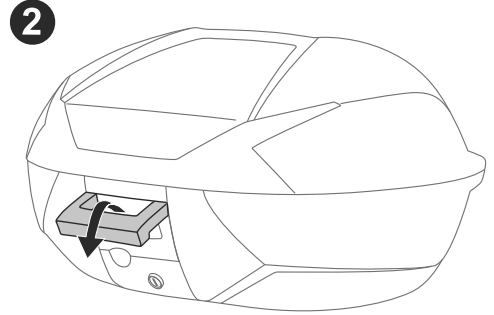
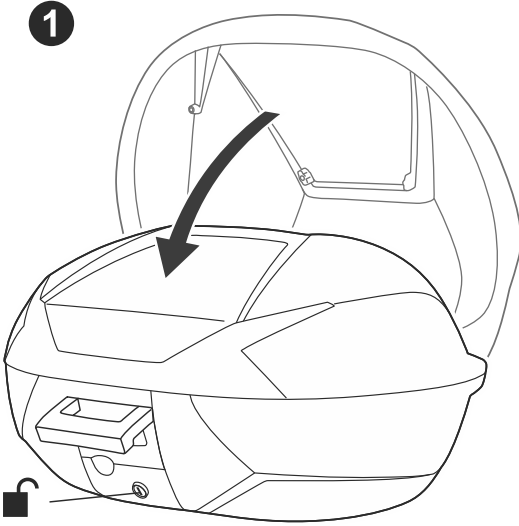

RELEASE

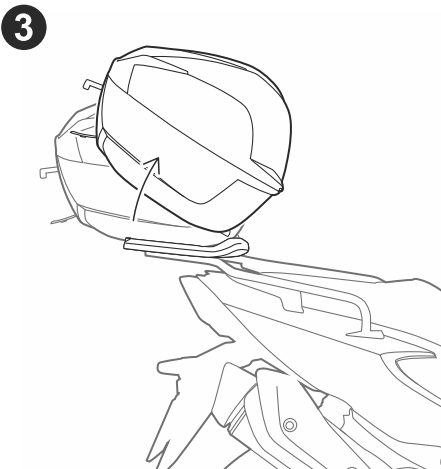
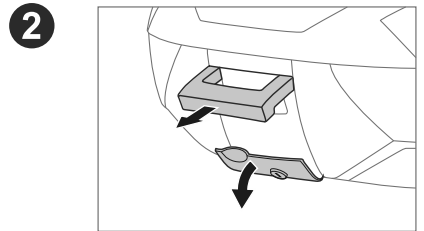
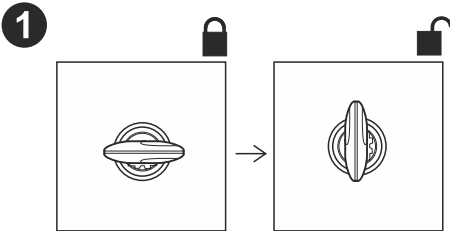

SH40 Cargo

* Only for SH40 Cargo

#	Piece	Quantity
1	Clip	4
2	Screw	4
3	Washer	4

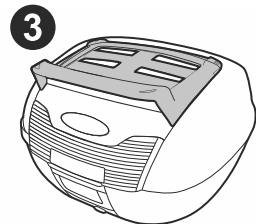
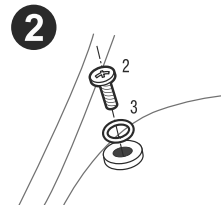
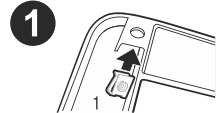

OPEN

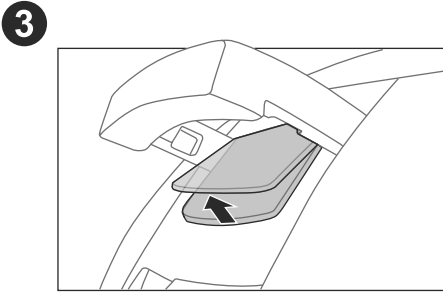
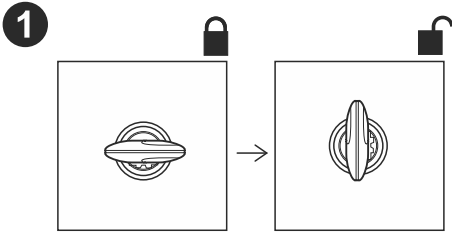

2

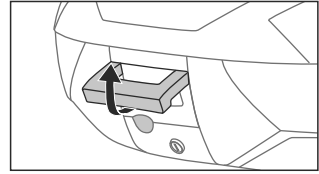

4

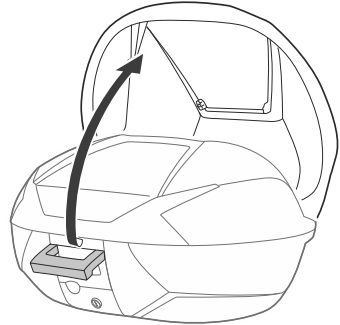

ASSEMBLY

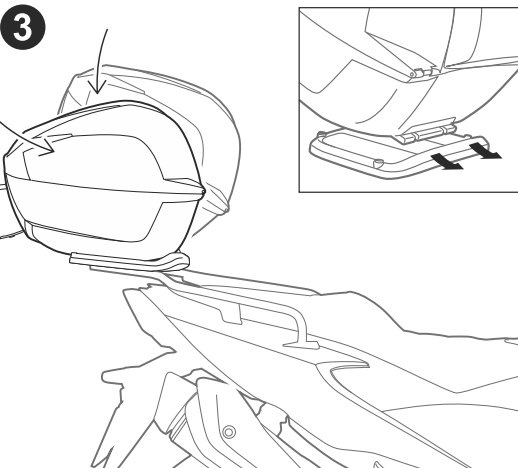
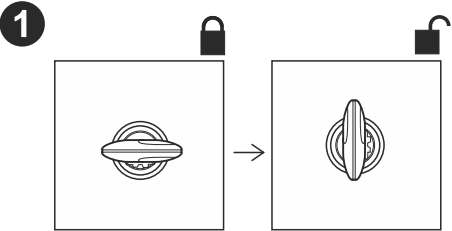

2

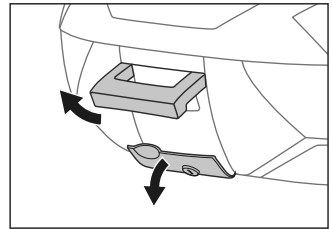

4

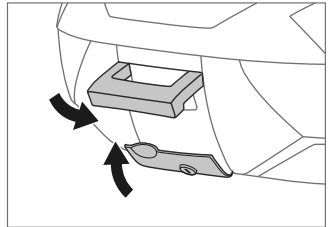

5

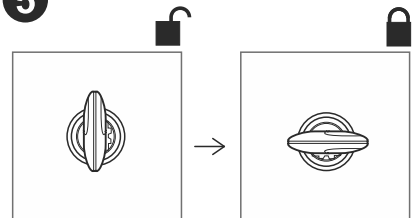

TOP CASE SUPPORT ASSEMBLY

Use top case parts

#	Piece	Quantity
1	Clip	4
2	Screw M6x40	4
3	Plastic spacer	4
4	Ø6 Washer M6	4
5	Nut M6	4
6	Screw M6x30	4

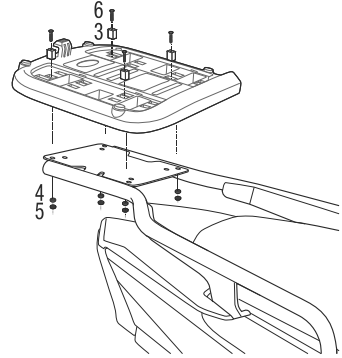
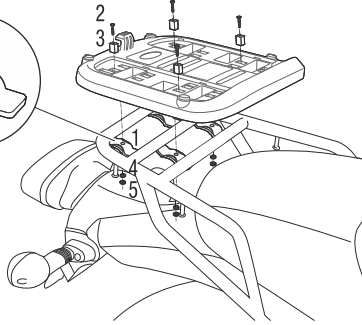
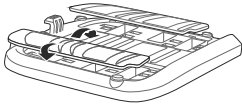

SHAD Top Master*

Use fitting kit parts

#	Piece	Quantity
7	Metal spacer	4
8	Screw M8x20	4
9	Washer M8	4
10	Nut M8	4



⚠ CHECK BIKE COMPATIBILITY
WWW.SHAD.ES *

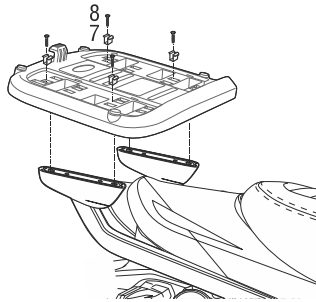

SHAD Top Master*

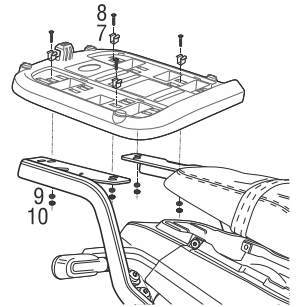

SHAD Top Master*

CARE AND MAINTENANCE



1 M. MINIMUM DISTANCE WITH POWER WASHER.



MAXIMUM WEIGHT.
(SH42, SH44, SH45, SH46, SH47)



MAXIMUM WEIGHT.
(SH40, SH40 Cargo)



ALWAYS SECURE AND LOCK PRODUCTS.



CASES ARE NOT DESIGNED TO PROTECT FRAGILE OBJECTS.



MAXIMUM SPEED, CHECK LOCAL LAWS.

SHAD
WWW.SHAD.ES

Octave Lecante, 2-6
Pol. Ind. Can Magarola
08100 MOLLET DEL VALLÈS
BARCELONA (SPAIN)

Phone: 0034 935 795 860
Fax: 0034 935 796 945
info@shad.es